

Hype-2 Digital Banner

HYPE-2-WHITE

The Hype Digital Banner is an ideal display for events, interior spaces and tradeshow. The Hype plays animations and portrait-oriented photos that act as promotional content. Great for retail spaces and tradeshow booths.



features and benefits:

- 1080x1920p Resolution LCD Panel
- 2x8W Stereo Loudspeakers
- Tempered glass for screen protection
- Remote control for setting adjustments (language change, slide duration, etc.)
- 8GB of internal storage
- An estimated run time of 50,000 hours

- USB thumb drive for content upload is optional (not included)
- Screen brightness: 450cd/m²
- 1 year manufacturer warranty
- Power requirements:

Watts: 400-960W	Amps: 4A	Volts: 100-240V
---------------------------	--------------------	---------------------------

dimensions:

Hardware

Assembled unit:
23.88" w x 59.06" h x 21.38" d
606mm(w) x 1500mm(h) x 543mm(d)

Approximate weight without case:
70 lbs / 31 kg

Graphic

Refer to attached instructions for content design and programming.

Shipping

Packing case(s):

1 black, hard-shelled, wheeled flight case with lockable lid
(ships freight on a pallet only)

Shipping dimensions:

69" l x 35" h x 13" d
1752mm(l) x 889mm(h) x 330mm(d)

Approximate total shipping weight (includes case and pallet):

135 lbs / 61 kg

additional information:

When included in a larger order, a different packaging solution will be provided to accommodate all contents of the order.

2 person assembly recommended:



This product may include the following materials for recycle:
aluminum, select wood, fabric, cardboard, paper, steel, and plastics.

We are continually improving and modifying our product range and reserve the right to vary the specifications without prior notice. All dimensions and weights quoted are approximate and we accept no responsibility for variance. E&OE. See Graphic Templates for graphic bleed specifications.

Instruction Index

Designing Content for the Hype	Page 3
Content Management Via USB Stick	Page 4
Controller Functions	Page 5
Powering On the Hype	Page 6
Connecting to CMS Server Application	Page 7
CMS Server Application - Device Connection	Page 8
CMS Server Application - Content Management	Page 9-10
CMS Server Application - Publishing Content to Hype	Page 11
CMS Server Application - Deleting Content from Hype	Page 12
Troubleshooting Power & Display Issues	Page 13

Designing Content For the Hype

Designing Images for the Hype

Requirements:

Hype Digital Banner
USB Drive (not included)
Windows or Mac Computer
Adobe Photoshop or similar software
Image Files (.JPG file format)

1. Format Your Image Files - Image should be 1080x1920 canvas size.
2. Once your design is complete save your images named in the order in which you would like it to be shown. (e.g. 1, 2, 3, etc.)



Image displayed on hype

Designing Animations for the Hype

Requirements:

Hype Digital Banner
USB Drive (not included)
Windows or Mac Computer
Adobe Premiere Pro, After Effects or similar software

1. Canvas size of animation should be 1080x1920.
2. Create your animation - Once your animation is completed, save your animations named in the order in which you would like it to be shown. (e.g. 1, 2, 3, etc.)

Content Management via USB Stick

How to upload files to a USB stick for use with the Hype

1. Plug the USB into your computer.
2. Build a “ContentDir” folder (Must be spelled with matching capital letters as seen) in root directory of USB stick (Do not put in to a sub-folder).
3. Build an “AutoPlayDir” folder (Must be spelled with matching capital letters as seen) in root directory of USB stick (Do not put into a sub-folder). Copy your image or animation files to this folder.
4. Build a “DELETE_ALL” folder (Must be spelled with matching capital letters as seen) inside the “ContentDir” folder. Do not put any files into this folder. This folder will automatically delete all files that were previously uploaded to the Hype.
5. Eject your USB stick from your computer then insert it into the display USB Port on the Hype. It will delete all previous files from the Hype if you included the “DELETE_ALL” folder. The following popup window should display - click OK or wait 20 seconds and the files in the “AutoPlayDir” folder will auto-copy to the Hype.

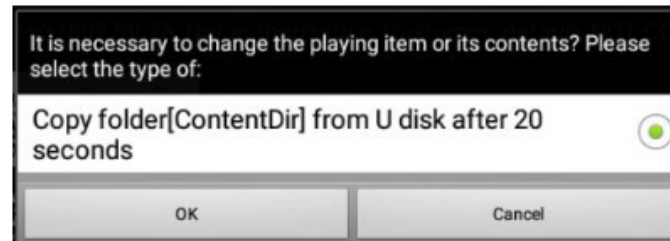

6. Once the auto-copy is finished, the Hype will automatically play all files. The USB stick is safe to remove once this happens.

Note: All image files will automatically play as a slideshow upon upload. Animated files will require that the play button be clicked. Do not upload image files with animation files via the USB stick as one of them will not play when uploaded together.

*** Please skip to next page if you plan on using the CMS Server to manage content. See page 8 for more information regarding the CMS Server Application.**

Controller Functions

Play Mode

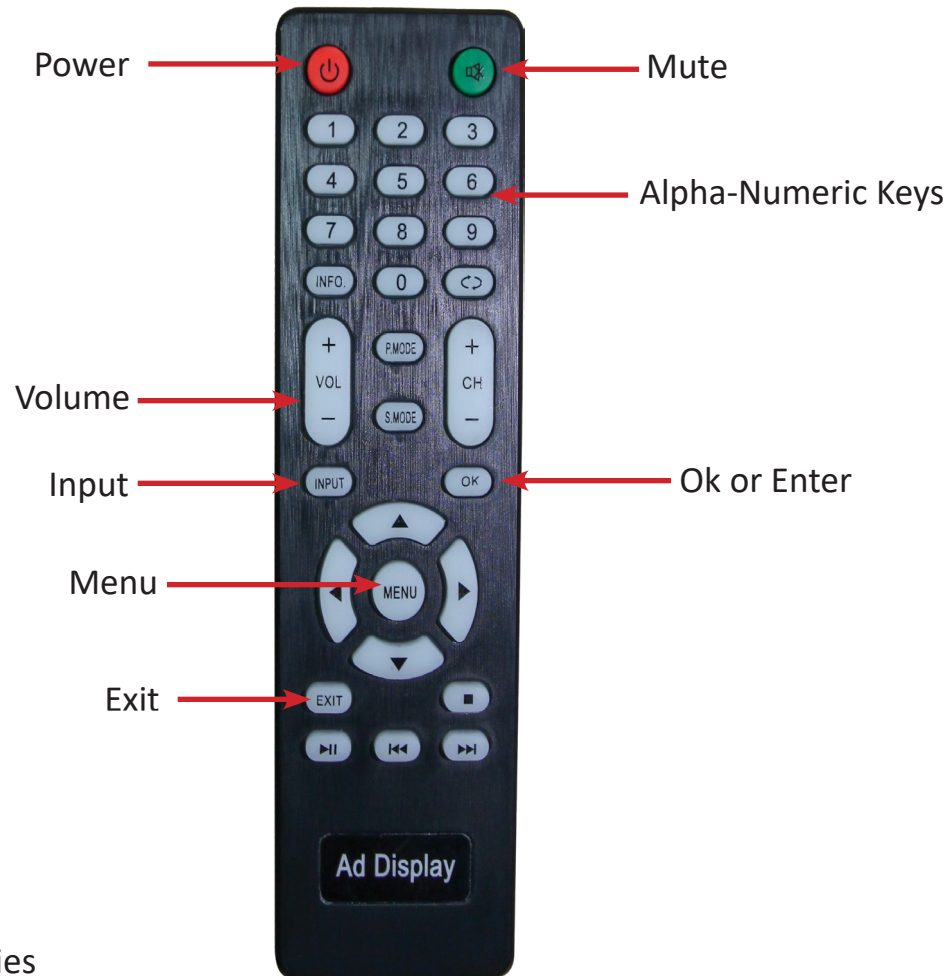

Takes 2 AAA batteries



Powering on the Hype

Powering on the Hype

1. Unlock and open the back panel of the unit with the key.



2. Locate the power supply unit. Plug the included power cord into the power supply unit and then plug into your outlet. Flip the power switch to the ON position. See troubleshooting page 13 if you have any trouble powering the unit on.

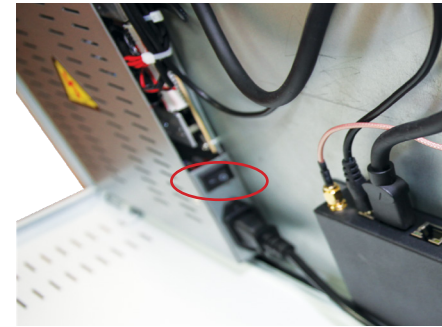

3. From the Android operating system home screen, enter the Settings menu by clicking on the gear icon at the bottom of the screen.

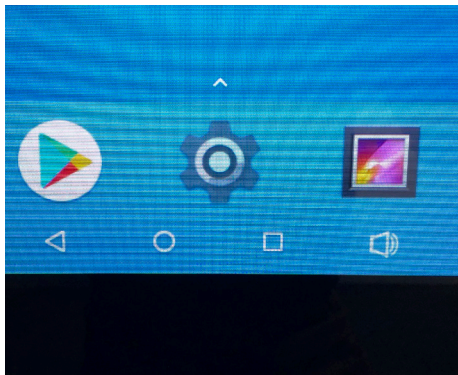

4. Click on the Wi-Fi tab to connect the unit to your Wi-Fi. Click on the square icon at the bottom of the screen to return back to the home screen.

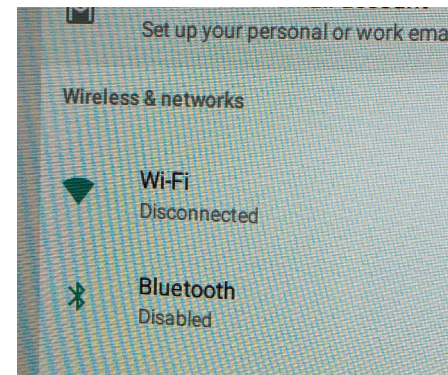

If faced with connectivity issues, toggle the Wi-Fi on the unit off then back on.

If the problem persists - power down the Hype, wait a few seconds then turn the unit back on.

Connecting to CMS Server Application

The CMS Server Application allows you to connect to your Hype remotely to update content. It also allows you to control content on multiple Hype units. All Hype units must be connected to the CMS Server to access this feature.

1. Launch the CMS on the Hype - from the home screen click on the CMS icon to launch the app.



3. Click on the Default buttons to ensure the default information is filled into the Custom Code and Server Address fields. Click OK at the bottom.

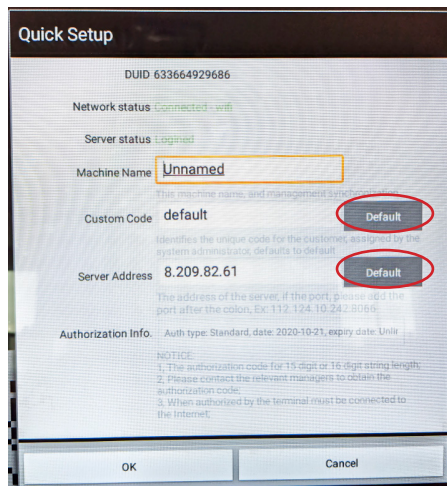

2. The following screen will be displayed. Click on the Quick Setup button at the bottom.

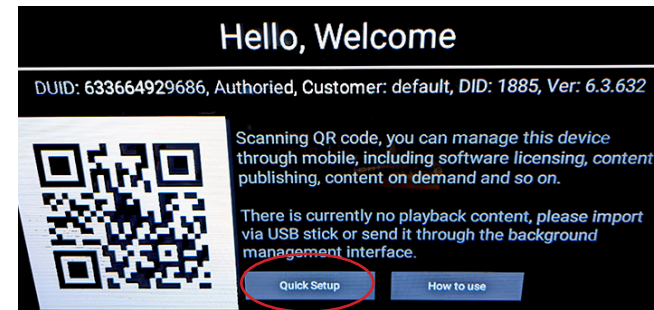

4. Once you have connected to the CMS Server it will display "Connection Server Succeeded" at the bottom of the display. If you have issues, please make sure you are connected to the Wi-Fi.

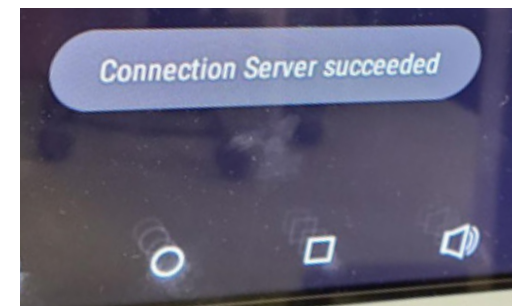

CMS Server Application - Content Management

4. You can access the content on your Hype by clicking on the Contents tab within the devices menu.

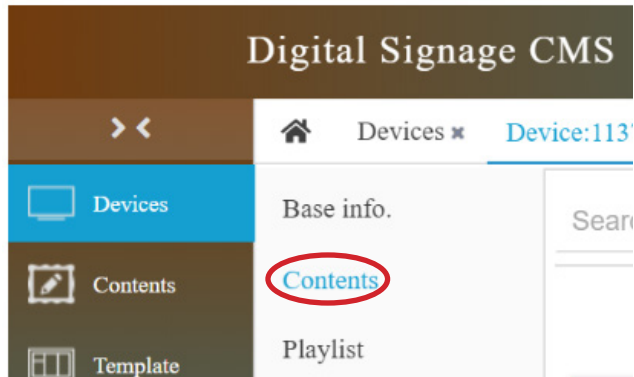

5. To update the displayed contents, click the regain Data button.

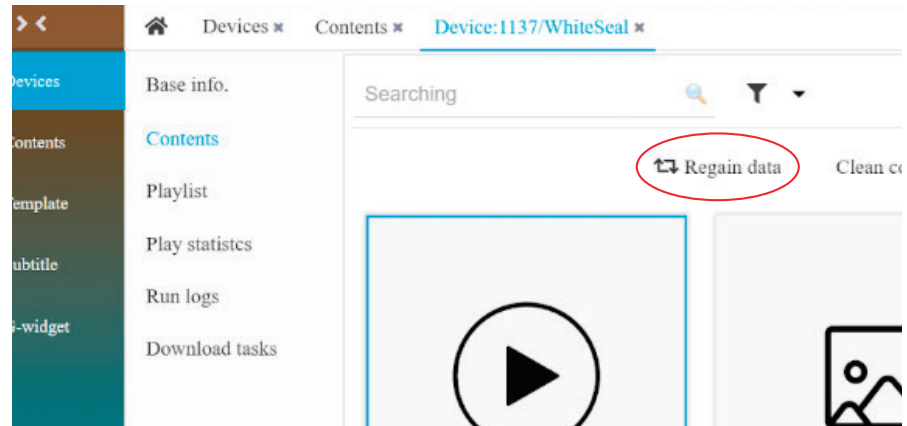

6. Uploading Content to the Hype- click on the menu in the top left corner and click on the template option from the pulldown.

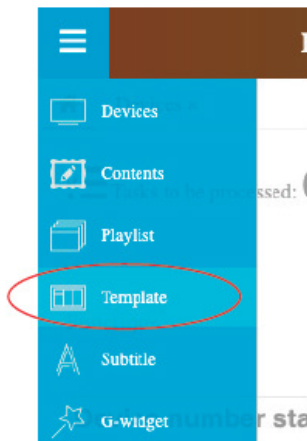

7. Select which template you would like to use and click the + icon at the top of the template pane (Add to Content). Typically you would select template 1/1 to show 1 image at a time.

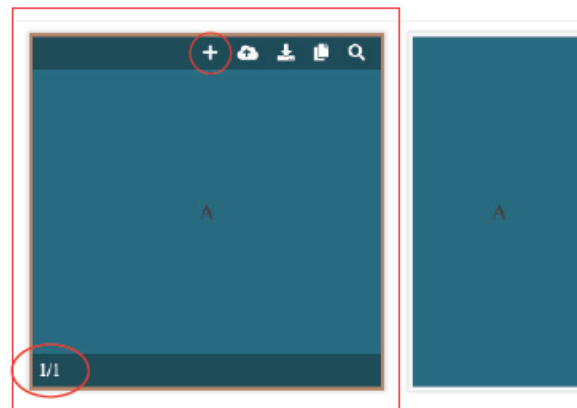

The other templates allow multiple images to display at the same time based on the configuration shown. We highly suggest that you combine your images in your design software to avoid any stretching of your images.

CMS Server Application - Content Management

8. A new Add window will appear. Click on the “+ Select” button next to “A-Area” then click on “Upload File” button to upload your image to the template. Then click OK.

Title: TwoCanyons

Preview on: Landscape 16x9

Template: 1

Catalog:

The selected template contains the following areas, please set at least one area content

A-Area: grandcanyon.jpg

Enter URLs, streaming addresses, etc.

Upload file

OK Cancel

9. Click OK at the bottom of the Add window to finalize your image upload to the server.

Title: TwoCanyons

Preview on: Landscape 16x9

Template: 1

Catalog:

The selected template contains the following areas, please set at least one area content

A-Area: grandcanyon.jpg

OK Cancel

10. Click Ok when the “Request Successfully” window pops up.

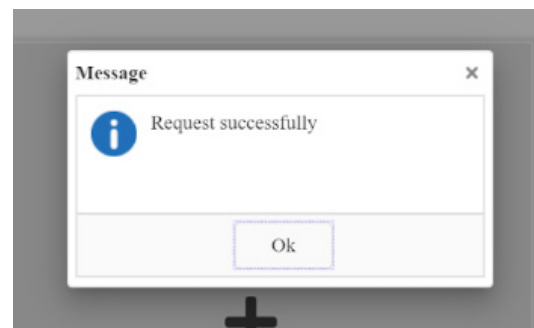

CMS Server Application - Publishing Content to Hype

1. From the CMS Home Screen, click on the Contents button.

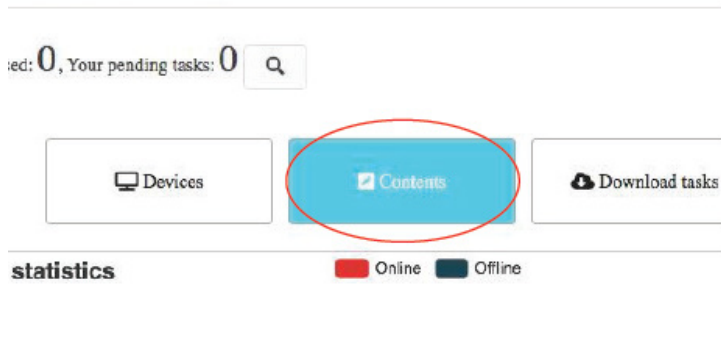

2. Click on which image/animation you'd like to add to your Hype. Click the Publish button in the bottom right corner of the screen. If the image is locked then select OK when asked if you are sure you'd like to unlock the data. Then click Publish.

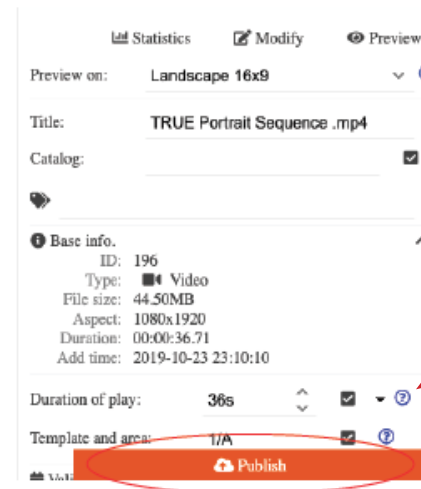

All images will default to 15 seconds of play but timing can be adjusted here

4. Update your Play Order to when you would like your image to be displayed in the sequence. Then click on + Select button next to Target Devices to select which Hype unit to Publish the image to.

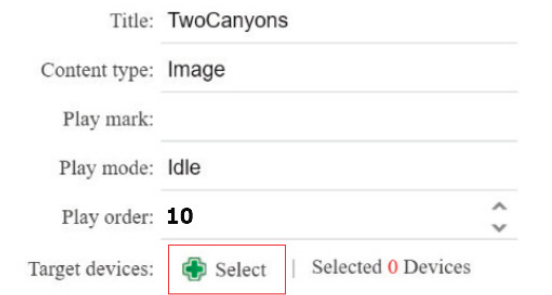

5. Click the checkbox of the device(s) you would like to upload the file to then click Select to return to the Publish content window then click OK to finalize your upload.

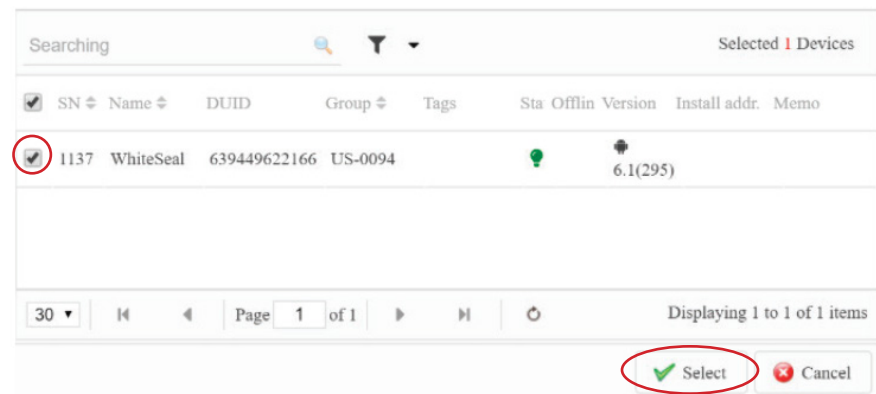

CMS Server Application - Deleting Content from Hype

1. Click on Devices button and click on the Hype unit you'd like to update contents on. Then click on the Contents button to the left.

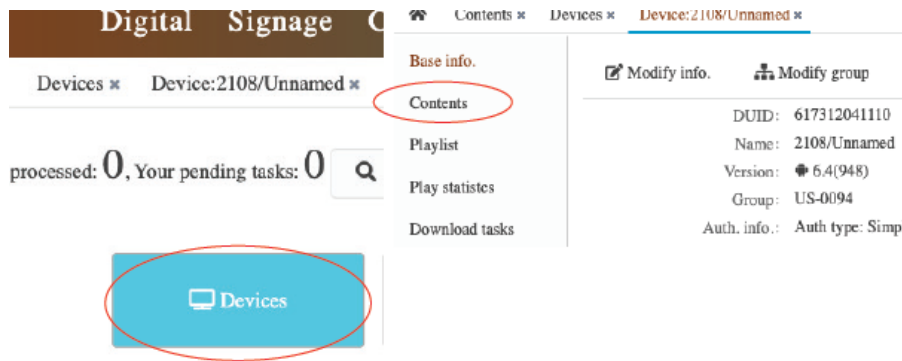

2. The Contents window will display all images and animations that are currently uploaded to the specific Hype unit that is selected.

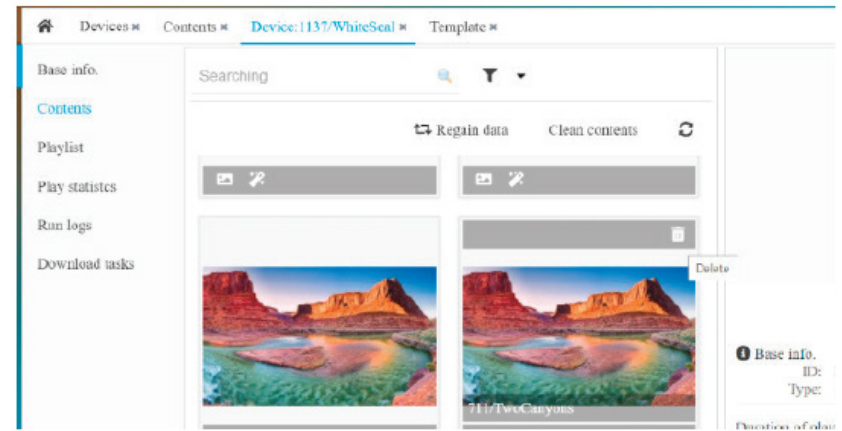

3. Hover over the file you wish to delete and a trash can icon will appear in the upper right corner. Click this icon to delete the file.

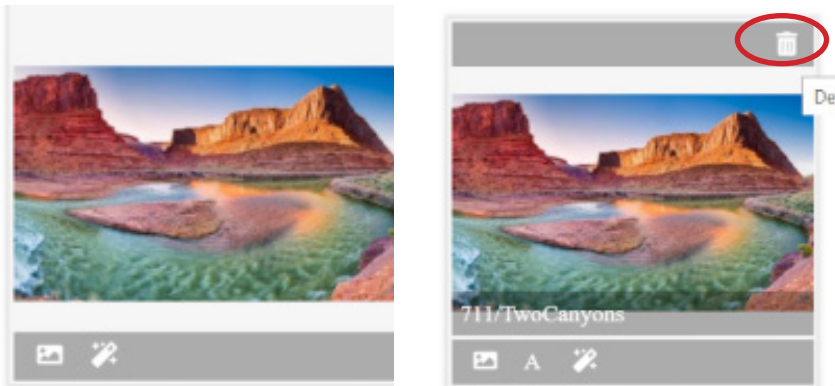

4. Click OK to confirm- the file is now deleted from the Hype unit.

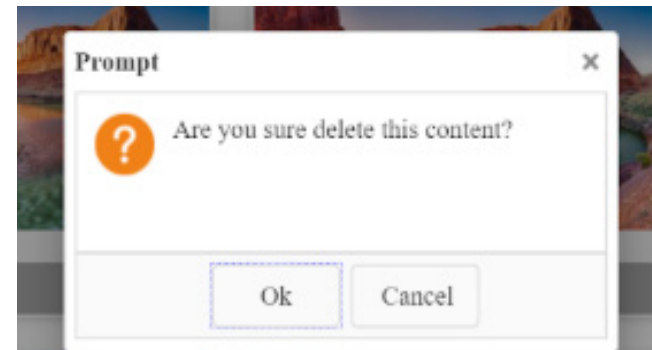

Troubleshoot Power & Display Issues

Power and Display Issues

When the power switch is flipped ON and the unit displays a blue screen with either of the following codes:

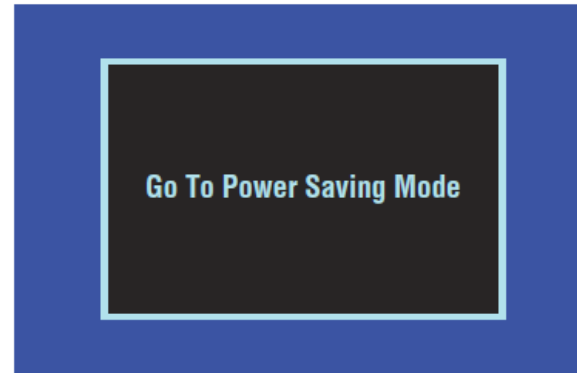
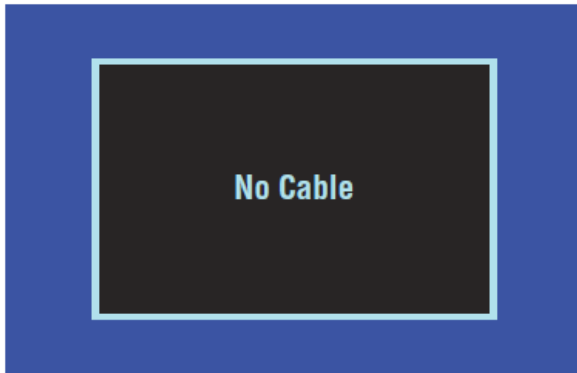

You are in the wrong cable configuration / Input setting.

Press the Input button on the remote. The Input menu should display on the Hype unit.
Use the arrow buttons on the remote to select HDMI followed by the menu button.

